

Introduction.

The following provides instructions for using the ScanX Cleaning Sheet to ensure optimal performance of the ScanX.



Reuse of the Cleaning Sheet may cause previously removed debris to be reapplied to the ScanX transport mechanism.

Dental Recommended Use.

When used in Dental practices, clean the ScanX once per month.

Veterinary Recommended Use.

When used in Veterinary applications, clean the ScanX once per day. Use a new ScanX Cleaning Sheet each time for best results.

Procedure.

1. Turn on and activate the ScanX using the 5 LP/mm resolution mode (Extraoral Standard).
2. Remove one Cleaning Sheet from the box.
3. As shown by Figure 1, peel the Release Liner away from the Cleaning Sheet exposing the tacky surface of the Cleaning Sheet.
4. Hold the ScanX Cleaning Sheet on the short edges with the tacky side facing the ScanX to be cleaned.
5. Continue holding the sheet between the finger tips of both hands, curl the long dimension of the ScanX Cleaning Sheet so the tacky side is on the inner (concave) side.



Avoid pressing the tacky side of the Cleaning Sheet against the Inlet to prevent excessive drag on the Cleaning Sheet.

6. Align the curl of the Cleaning Sheet with the ScanX Inlet (See Figure 2.), and while slightly leaning the Cleaning Sheet away from the inlet surface, insert the leading edge of the Cleaning Sheet into the inlet slot of the ScanX.
7. Slowly and carefully, tilt the Cleaning Sheet towards the ScanX while gently pushing the Cleaning Sheet into the inlet slot until the transport mechanism grasps the sheet and transports it into the ScanX.
8. Allow the Cleaning Sheet to run through the ScanX until it completely exits the transport.
9. If the Cleaning Sheet appears clean enough for re-use, store it by placing the sheet with tacky side down onto the glossy side of the Re-usable Release Liner as shown by Figure 3.

ScanX Cleaning Sheets

Box of 12, P/N B2010

Box of 25, P/N B2020

One Re-usable Release

Liner is included in each box.

ScanX Cleaning Sheet Tacky Side

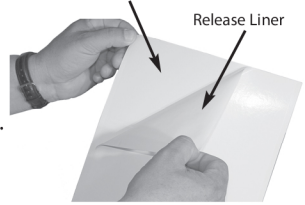

Figure 1. Peeling the Release Liner from the ScanX Cleaning Sheet



Figure 2. Aligning the ScanX Cleaning Sheet with the Tacky Side Facing the Inlet

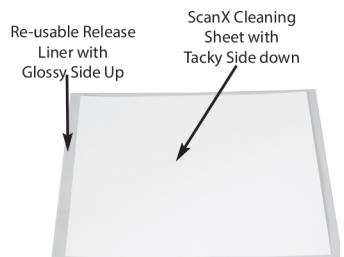

Figure 3. Storing a ScanX Cleaning Sheet on the Re-usable Release Liner