

Mojave LT Motor Replacement Kit

Part No: H4150 and H4151

Replacement Instructions

Introduction

This document provides instructions for using replacement kits (P/N H4150 and H4151) to replace a motor assembly of a MOJAVE LT Dry Vacuum System.

Important Information

Service Personnel

All personnel servicing the MOJAVE LT system must read and understand the Operator's Manual before operating or performing any service of the unit. Only a trained technician from a qualified Air Techniques dealer should perform any service.

Power Removal

Never work on equipment connected to live power. Remove power by disconnecting mains power to the unit prior to performing any replacement procedures.

Motor Replacement / Refurbished Kit Components Supplied

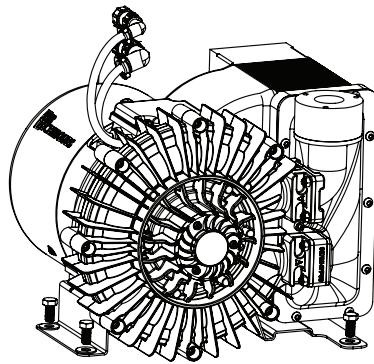

Motor Assembly

Motor Replacement Procedure

Replace the faulty motor using the replacement or refurbished motor by performing the following steps.

1. Turn power to the device OFF.
2. Remove any hoses connected to the motor exhaust port.
3. Disconnect the brown MOTOR and orange MOTOR FAN circular connectors from the back of the electrical box by loosening the locking ring closest to the electrical box on each connector.

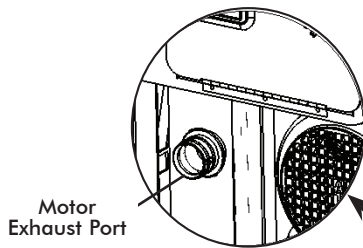

Motor Exhaust Port

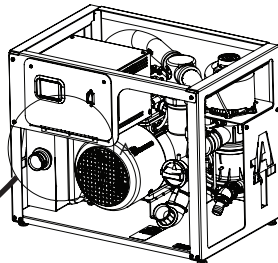

Mojave LT Front View

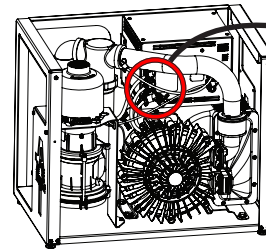

Mojave LT Rear View

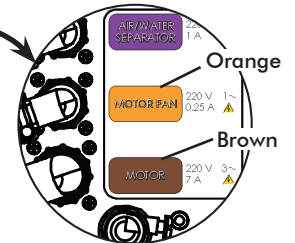

MOTOR and MOTOR FAN Connections

4. Using a 4 mm hex key, remove the (3) bolts and washers securing the inlet manifold to the motor inlet.
5. Using a 9/16 inch wrench, remove the (3) bolts and washers securing the motor to the bottom chassis.

Note: Use extra caution not to damage the grounding lug for the Air Water Separator.

6. Slide the motor out from the unit chassis.
7. Insert the replacement motor, aligning the (3) mounting holes to the holes in the bottom chassis.
8. Insert the (3) bolts and washers to secure the motor to the bottom chassis.

Note: The Air Water Separator grounding lug should be between the washer and bolt head. Do not overtighten the bolts.

9. Insert and tighten the (3) bolts securing the inlet manifold to the motor inlet.
10. Re-connect the brown "MOTOR" and orange "MOTOR FAN" circular connectors to the back of the electrical box by tightening the locking ring closest to the electrical box on each connector.
11. Reconnect any hoses which were disconnected from the motor exhaust port.
12. Turn power to the device ON.

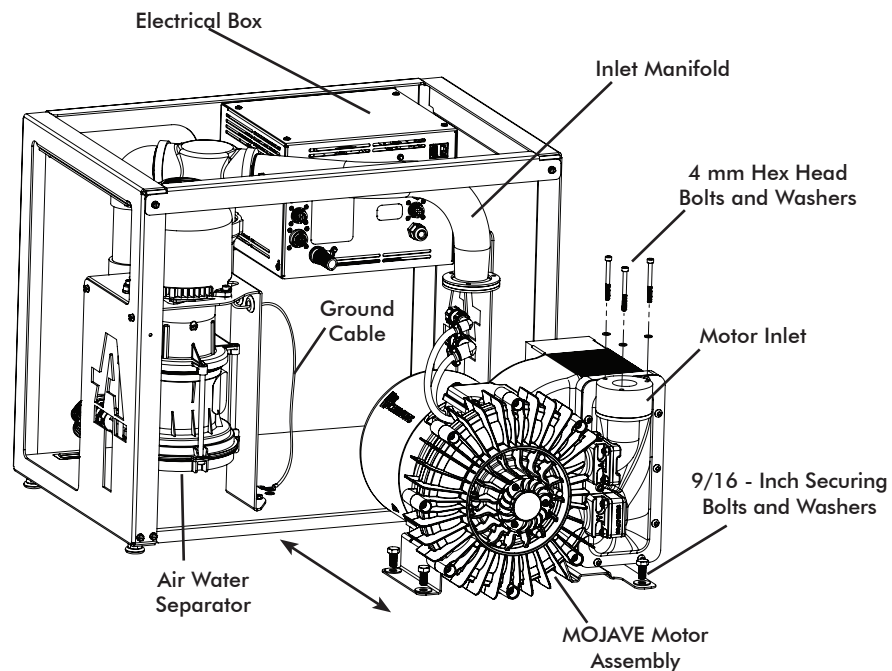

Motor Reshipment Packaging

Use the original packing material that provides adequate coverage and protection of the motor during shipment.

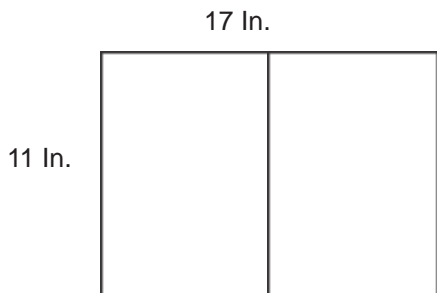

8 1/2" x 11" Book

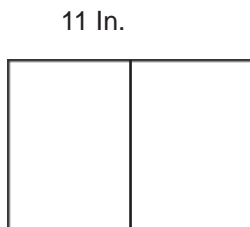

8 1/2" x 5 1/2" Book

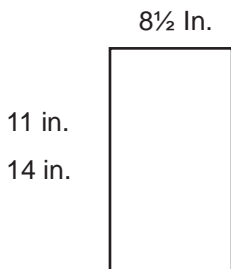

Print Single Side
Print Double Side

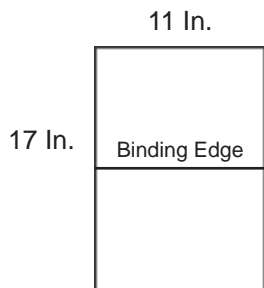

No Hole Punch
3-Hole @ Binding Edge

DATE	REV	REVISION RECORD	AUTH	DWN	CK
			SFJR		KML

Comments:

Application File Type:

In Design	Quark XPress
PDF (for viewing)	MS Word
CorelDraw	WordPerfect

Air Techniques Storage Location:

Stored by document part number in one of the network release drive directories checked below.

Manuals	Instructions
---------	--------------

Finished Document Print Requirements

Doc size:
Total sheets:

Paper requirements	Weight	Brightness	Finish
Standard			
Custom			

Print Black & White

- Additional Options:**
- Print in Color
 - Card Stock
 - Saddle Stitch / Fold (Staple Binding).
 - UV Coat Both Sides
 - Laminate
 - 3-Hole Binding
 - Single hole punch left corner front side
 - Spiral Bound Booklets
 - Wire-O Booklets (Metal Coil Binding)

Artwork print file provided by Air Techniques

Important:

Make sure to print only the latest revision from the network release drive using the original document file for best printing results.
Never print scanned copies from the (engscan network drive).

AIR TECHNIQUES equipped for life®		DRAWN	
MATERIAL SEE FE A H S	TITLE		
FINISH SEE FE A H G			
DATE	SIZE 5	PART NO.	REV