

MOJAVE™

DRY VACUUM SYSTEM

CT20 Dual Continuum Tank Product Overview

Delivered Components

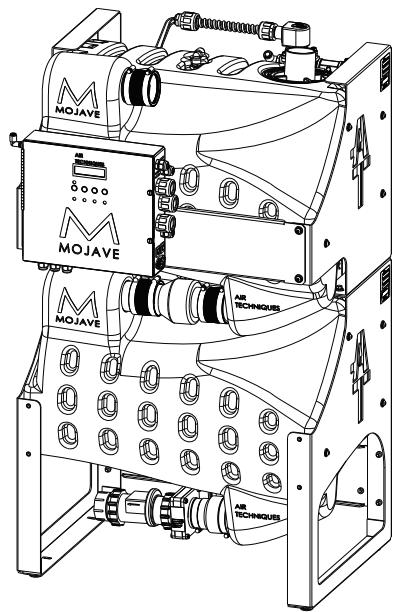

Fully Assembled CT20
Dual Continuum Tank Unit

CT20 Dual Continuum Tank Accessory Pack, P/N H5243

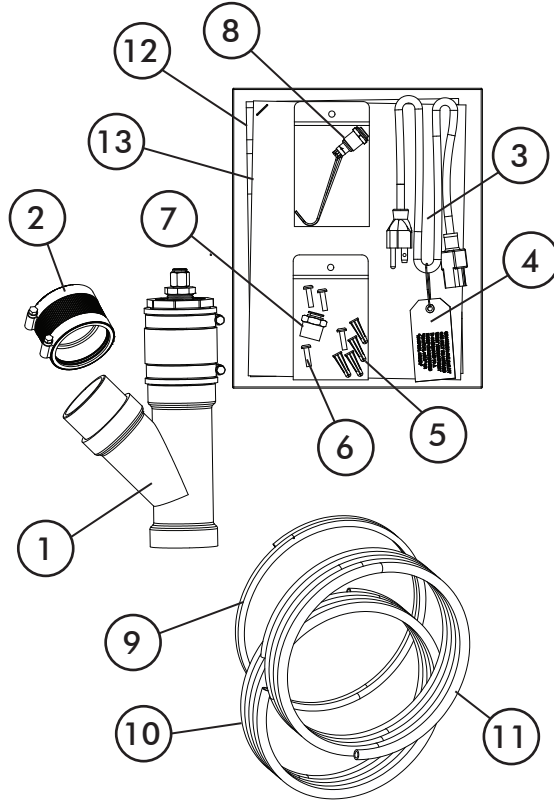

Item	Part No.	Description	Qty
1	H5302	Exhaust Vent Assembly	1
2	H5234	2" to 2" Flexible Coupling Connector	1
3	77243	Mojave Master Controller Line Cord 10 Feet, 18 GA., IEC X North America, Hospital Grade	1
4	61022	Hospital Receptacle Only TAG	1
5	30936	Plastic Screw Anchor, #10-12 X 1"	4
6	30295	#10 X 3/4, Type A, Plated Slot Pan Head Screw	4
7	56194	Connector Adapter, 1/2" MNPT X 3/8" PUSH	1
8	53202-1	Switch Assembly; Push Button, Panel Mount, GRN/YEL, 6V LED	1
9	51453	Urethane Tubing, 1/4" OD	5 Ft
10	19271	Poly Tubing, 3/8" OD	10 Ft
11	54509	Poly Tubing, 85A, 10MM OD, 6.5MM ID, TBLU: FW# A40108:	10 Ft
12	H5153	User's Manual V3, V5, V7, 2V3, 2V3CT, 2V5, 2V5CT, 2V7, 3V5 & 4V5	1
13	9922-479	Cleanstream Cleaning Poster	1

CT20 Dual Continuum Tank Assembly

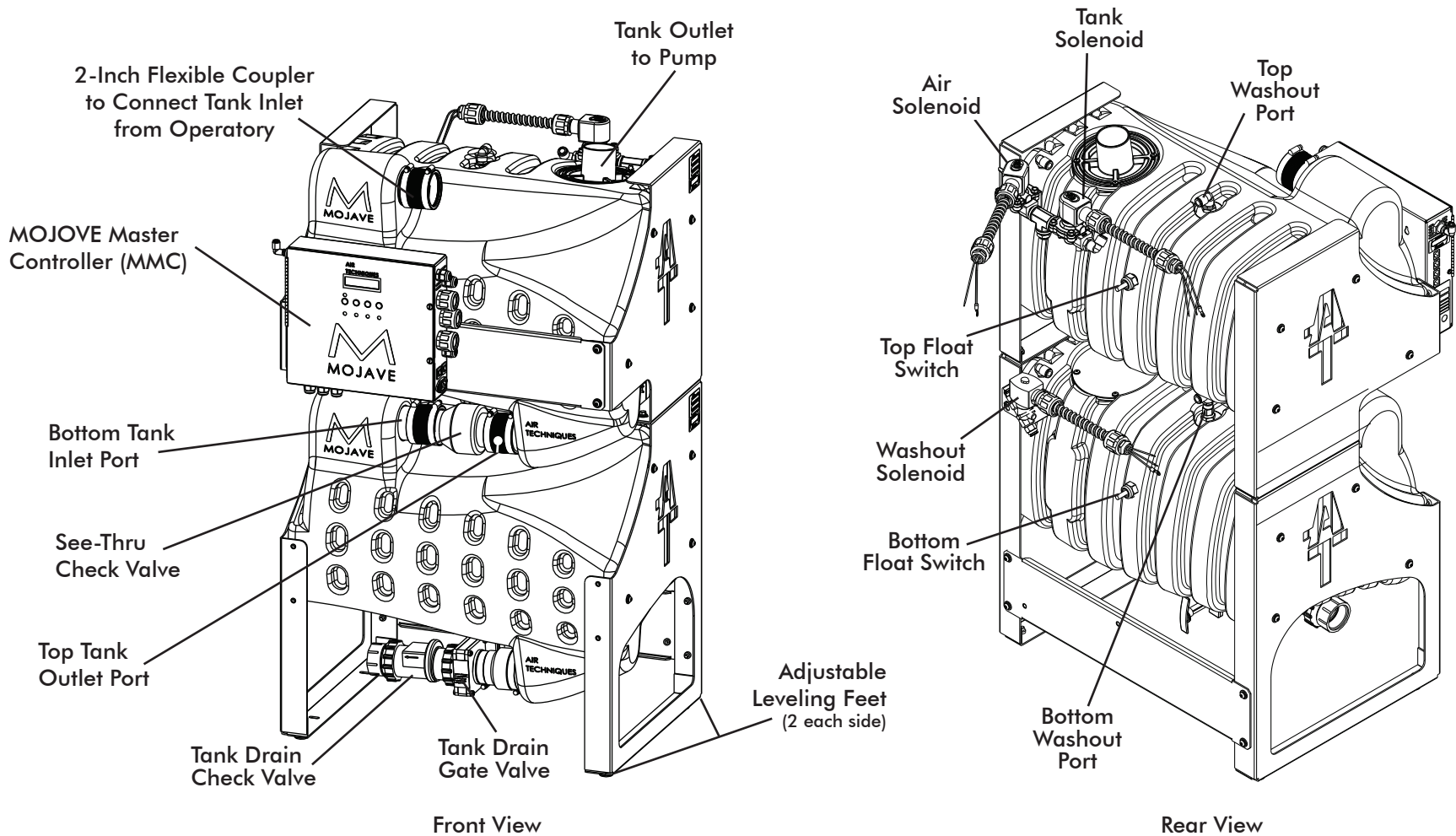

www.airtechniques.com



Corporate Headquarters
1295 Walt Whitman Road | Melville, New York 11747-3062, USA
Phone: 1-800-247-8324 | Fax: 1-888-247-8481



Solenoid Tubing Connections

Connections between the control solenoids must be made for the automatic operation and maintenance of the CT20 tank. Refer to the illustration at right and make sure that the connections are correct between the connection points listed below.

CT20 Solenoid Tubing Air/Vacuum Connections	
Point A to B	Connects the vacuum of the top and bottom tank sections via the Tank Solenoid.
Point C to D	Connects the vacuum of the top and bottom tank sections via the Tank Solenoid.

CT20 Solenoid Tubing Water Connections	
Point E to E1	Connects the facility water source to the top and bottom tank Washout Ports via the Washout Solenoid.
Point E2 to F	Connects the facility water source to the top and bottom tank Washout Ports via the Washout Solenoid.
Point E3 to G	Connects the facility water source to the top and bottom tank Washout Ports via the Washout Solenoid.
Point H	Facility water input

Vent Line Drip Leg
 Make sure to install the Exhaust Vent Assembly to the bottom end of the facility vent line using items 1 & 11 of the CT20 Dual Tank Accessory Pack, P/N H5243.

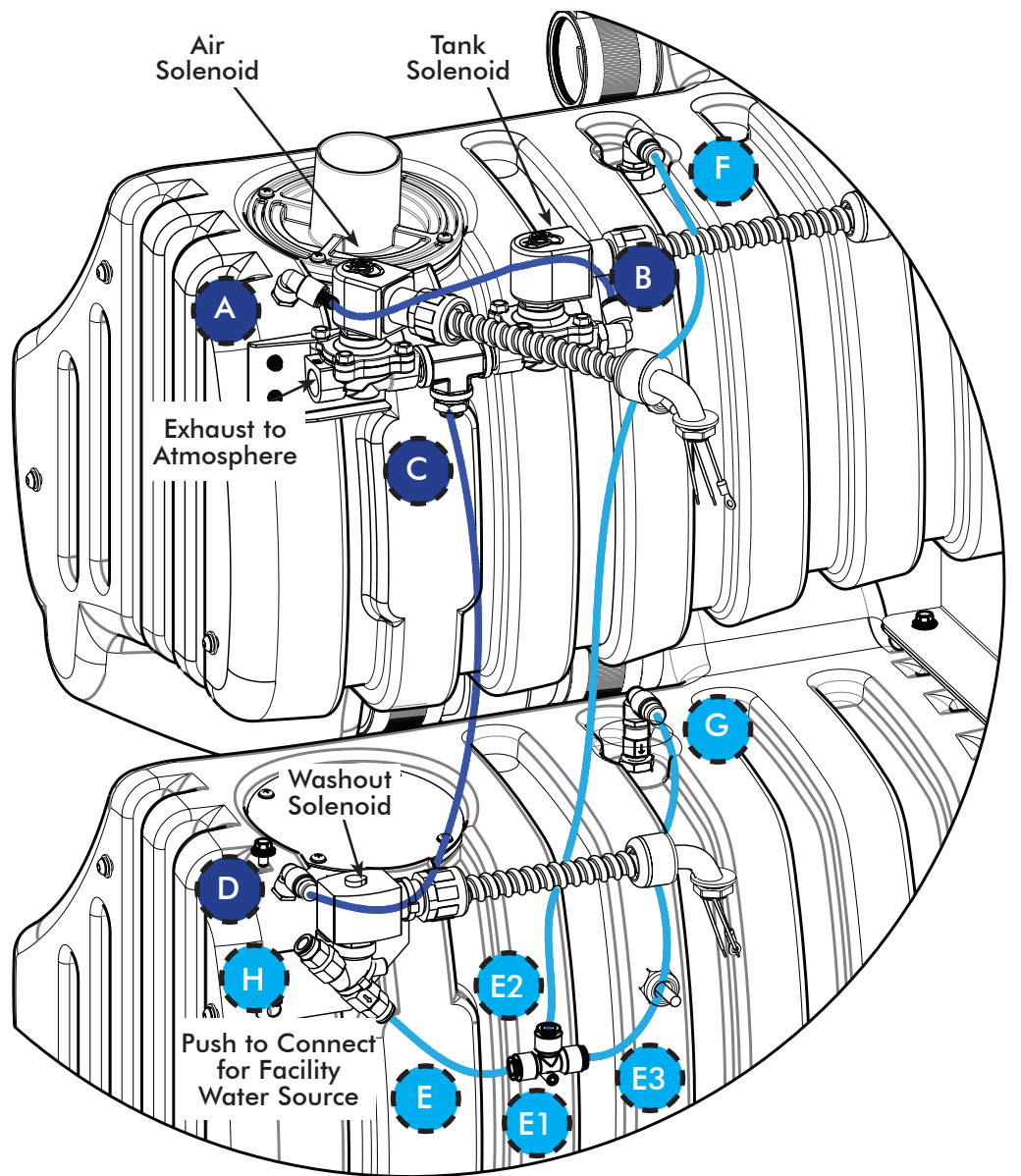

CT20 Tank Solenoid Tubing Connections

Solenoid Electrical Connections

MMC Connector	Function
J2	Main Water Panel Switch <i>Optional equipment install at site.</i>
J4	Main Water Solenoid <i>Optional equipment install at site.</i>
J6	Washout Solenoid <i>Connected at factory.</i>
J7	CT20 Tank Solenoid <i>Connected at factory.</i>
J8	CT20 Air Solenoid <i>Connected at factory.</i>
J14	Drain Pump <i>Optional equipment install at site.</i>
J10	Bottom Float Switch <i>Connected at factory.</i>
J11	Top Float Switch <i>Connected at factory.</i>
J12	Remote Panel Switch #53202-1
J13	<i>Install at site.</i>
J15 Thru J18	10-foot CAT 5 Cable to each Pump <i>Connect at site.</i>

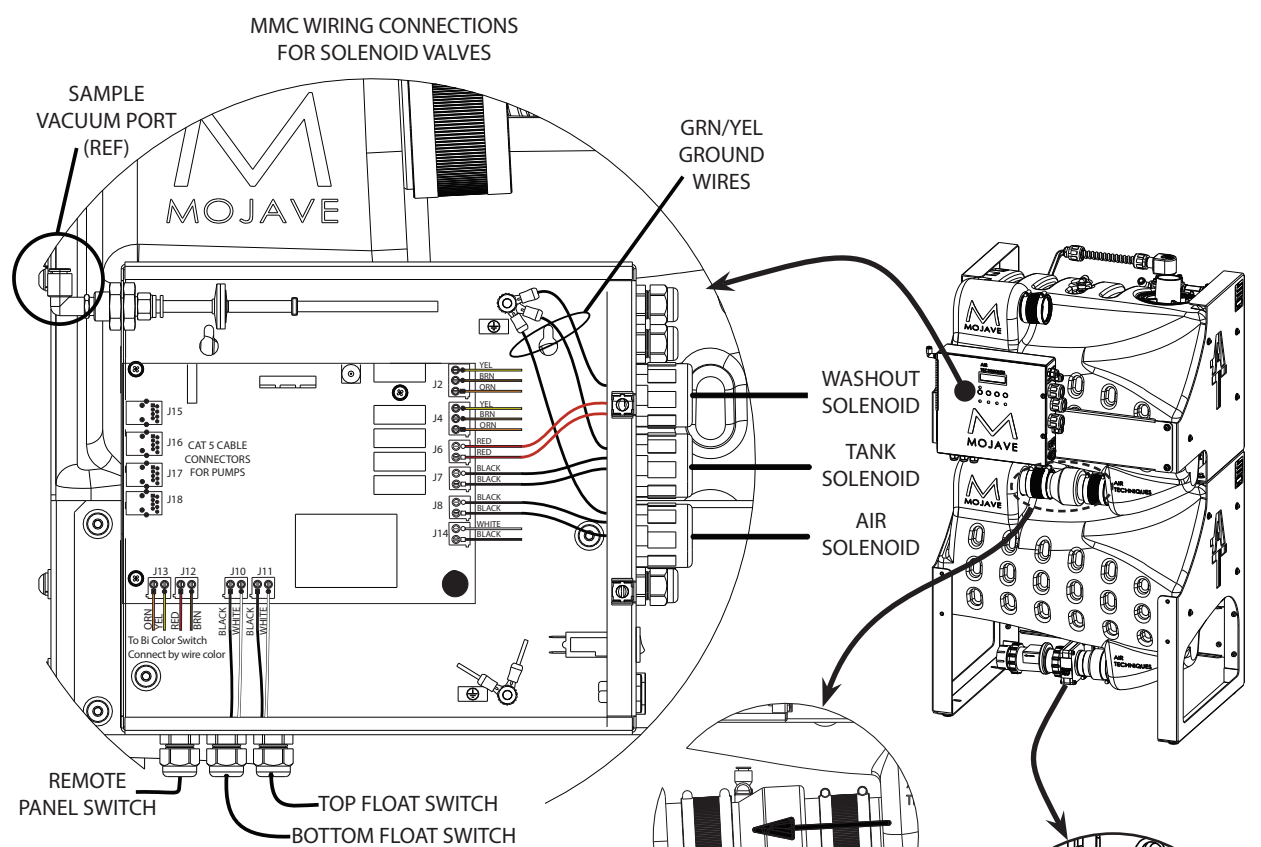

Important - Check Valve:
 For proper operation, the Check Valve must be installed with the flow arrow positioned on top and pointing towards the inlet port of the bottom tank.

Important - Gate Valve:
 For proper operation, make sure that the Gate Valve of the Tank Drain is set in the open position.
 Closing the Gate Valve will stop all drainage from the tank.

MOJAVE Plumbing & Electrical Connections
 Refer to the User's Manual, P/N H5153, and Pre-Installation Guide, P/N H5187, as needed for information on the plumbing and electrical connections necessary to complete the CT20 tank installation.

Tank Drain Gate Valve