

MOJAVE®

DRY VACUUM SYSTEM

V3, V5 & V7 Power Module Replacement Kits

Part Nos: H5223, H5225, H5635, H5643 and H5645

INSTRUCTION SHEET

Introduction.

This document provides instructions for using replacement kits P/N H5223, H5225, H5635, H5643 and H5645 to replace a Power Module assembly of a MOJAVE Dry Vacuum System. Use the replacement kit listed below corresponding to the MOJAVE Power Module being replaced.

Power Module Replacement Kit Components Supplied

MOJAVE Pump	Kit Part No.
V3PUMP-L	H5223
V5PUMP-L	H5225
V3PUMP	H5643
V5PUMP	H5645
V7PUMP	H5635

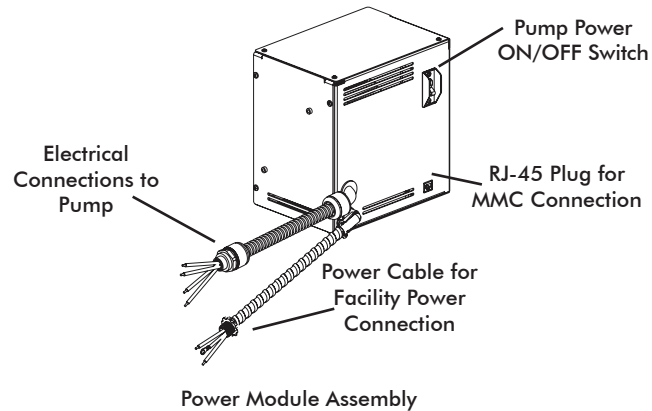

Note: Each kit contains the attaching hardware necessary to secure the replacement module to the pump chassis.

Important Information.

Service Personnel

All personnel servicing the MOJAVE system must read and understand the Operator's Manual before operating or performing any service of the unit. Only a trained technician from a qualified Air Techniques dealer should perform any service.

Power Removal

Never work on equipment connected to live power. Remove power by disconnecting mains power to the unit prior to performing any replacement procedures.

Power Module Replacement Procedure. Replace the faulty Power Module by performing the following steps.

1. Make sure to place the Pump Power On/Off Switch in the Off position and remove all mains power before performing any replacement procedures.
2. Using a #2 Phillips screwdriver, remove the cover from the electrical connection box located on top of the pump.
3. Using a #2 Phillips screwdriver, disconnect the green with yellow stripe ground wire.
4. Disconnect the black, red and white wires.
5. Remove the strain relief and harness assembly from the electrical connection box of the pump.
6. Disconnect the CAT-5 cable from the RJ-45 connector plug.

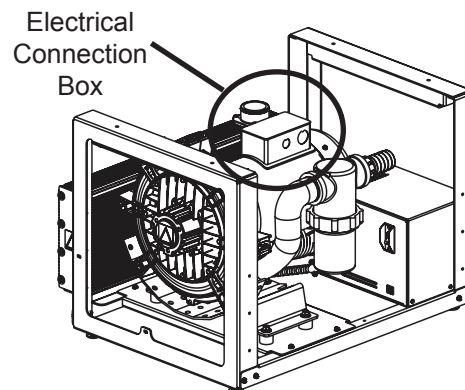

Electrical Connection Box Location

7. Disconnect the black, white and green with yellow stripe wires of the handy box connecting the power module to facility input power.
8. Using a #2 Phillips screwdriver, remove the two screws and washers from the right side of the pump chassis as shown by Detail 1.
9. Using a #2 Phillips screwdriver, remove the four screws securing the front panel as shown by Detail 2. Remove the panel and set aside.
10. Using a 5/16 inch nut driver, remove the screw from the lower left of the power module as shown by Detail 3.
11. Remove the faulty power module from the pump chassis by carefully lifting it up and away. Install the front panel removed by step 9 and set the power module aside for reshipment to the factory.

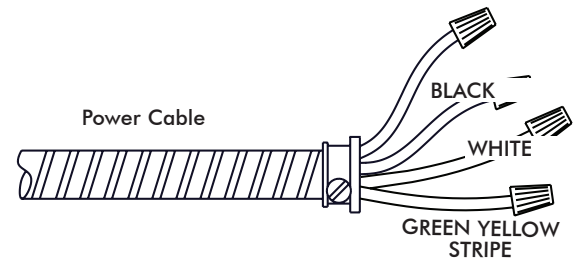

Facility Power Connection for MOJAVE Pump

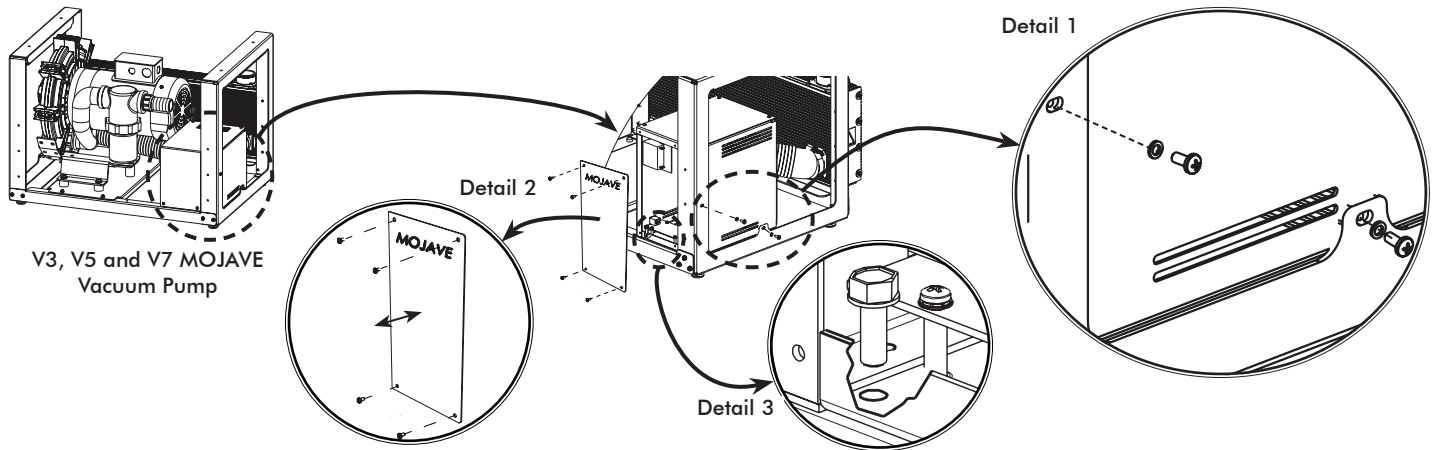

V3, V5 and V7 Power Module Assembly Replacement

12. Using a #2 Phillips screwdriver, remove the three screws securing the top panel of the replacement power module. Remove the panel and set aside.
13. Install the replacement Power Module Assembly to the pump chassis by checking for proper orientation and carefully lowering the assembly onto the corresponding installation space. Secure the power module to the chassis as follows.
 - a. Install two screws and washers removed by step 8 into the corresponding screw holes on the right side of the pump chassis as shown by Detail 1. Tighten using a #2 Phillips screwdriver.
 - b. Install the screw removed by step 10 above into the corresponding screw hole on lower left of the power module as shown by Detail 3. Tighten using a 5/16 inch nut driver.
 - c. Install the top panel removed by step 12 and secure with three screws.
 - d. Install the replacement front panel (See Detail 2) and secure with four screws.
14. Slide the harness assembly into the electrical connection box and install the strain relief nut. Connect the black, red and white harness wires to the electrical connection box wires listed below corresponding to the module being replaced.

V3 and V5 Connections

Black harness wire to connection box wire.	T1 Red
Red harness wire to connection box wire	T2 White
White harness wire to connection box wire	T3 Blue

V7 Connections

Black harness wire to connection box wire	T1 Blue
Red harness wire to connection box wire	T3 Orange
White harness wire to connection box wire	T2 White

15. Insert the green with yellow stripe ground wire onto the ground screw and tighten using a #2 Phillips screwdriver.
16. Place the cover on the connection box making sure that the rubber gasket is properly aligned. Install four screws and secure with a #2 Phillips screwdriver.
17. Connect the CAT-5 cable into the RJ-45 connector plug.
18. Connect the black, white and green with yellow stripe wires of the handy box to facility input power as shown by the Facility Power Connection for MOJAVE Pump illustration above. Close and secure the cover of the handy box.

Power Module Reshipment Packaging

Repackage the power module to return it to the factory for evaluation. Use the original or similar packing material that would provide adequate coverage and protection of the module during shipment.