

MOJAVE®

DRY VACUUM SYSTEM

V3, V5 & V7 Vacuum Pump Assembly Replacement / Refurbished Kits

Part Nos: H5213, H5213R, H5215, H5215R, H5217 & H5617R

INSTRUCTION SHEET

Introduction

This document provides instructions for using replacement kits (P/N H5213, H5215, H5617) and refurbished kits (P/N H5213R, H5215R, H5617R) to replace a vacuum pump assembly of a MOJAVE Dry Vacuum System. Use the replacement or refurbished kit corresponding to the MOJAVE vacuum pump being replaced as follows.

Vacuum Pump Replacement / Refurbished Kit Components Supplied

MOJAVE pump	Kit Part No.
V3	H5213
V5	H5215
V7	H5617
V3	H5213R
V5	H5215R
V7	H5617R

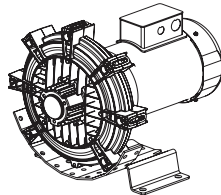

Vacuum Pump
Assembly

Flange
Gasket



5 mm Hex
Wrench

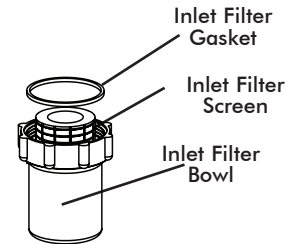

Important Information

Service Personnel

All personnel servicing the MOJAVE system must read and understand the Operator's Manual before operating or performing any service of the unit. Only a trained technician from a qualified Air Techniques dealer should perform any service.

Power Removal

Never work on equipment connected to live power. Remove power by disconnecting mains power to the unit prior to performing any replacement procedures.

Pump Replacement Procedure

Replace the faulty vacuum pump using the correct replacement or refurbished pump by performing the following steps.

1. Make sure to remove all mains power before performing any replacement procedures.
2. Using a #2 Phillips screwdriver, remove the cover from the electrical connection box.
3. Disconnect the green with yellow stripe ground wire using a #2 Phillips screwdriver.
4. Disconnect the black, red and white wires.
5. Remove the strain relief and harness assembly from the electrical connection box of the motor.

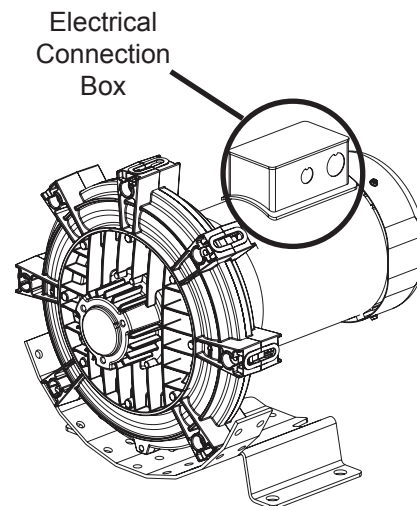

Electrical Connection Box Location and Connections

6. Disconnect and remove the inlet and outlet hoses from the vacuum pump to be replaced.
7. Using a 7/16 inch crescent wrench, loosen and remove the nut, lock washer and flat washer from each of the five shock mount studs securing the vacuum pump to the pump chassis.

Warning: Vacuum Pump weighs in excess of 70 pounds and a two person lift may be required to prevent injury when removing or replacing.

8. Remove the faulty vacuum pump from the pump chassis by carefully lifting it up and away. Set aside for reshipment to the factory.
9. Using the 5 mm Hex Wrench provided, remove the Inlet Filter Assembly and associated flange gasket from the inlet port of the vacuum pump to be replaced.
10. Install the Inlet Filter Assembly with the replacement flange gasket to the inlet port of the replacement vacuum pump. Tighten using the 5 mm Hex Wrench provided in the kit. Replace the inlet filter bowl, screen and gasket.
11. Using a 7/16 inch crescent wrench, loosen and remove the nut, lock washer and flat washer from each of the four bolts securing the vacuum pump to the shipping pallet.
12. Install the replacement vacuum pump to the pump chassis by checking for proper orientation and carefully lowering the pump assembly onto the corresponding shock mount studs.
13. Secure the pump by installing a flat washer, lock washer and nut to each shock mount stud. Tighten with a 7/16 inch crescent wrench.

14. Install the inlet and outlet hoses and secure with associated clamps.

15. Slide the harness assembly into the electrical connection box and install the strain relief nut. Connect the black, red and white harness wires to the associated electrical connection box wires as follows.

V3 and V5 Connections

Black harness wire to connection box wire.	T1 Red
Red harness wire to connection box wire	T2 White
White harness wire to connection box wire	T3 Blue

V7 Connections

Black harness wire to connection box wire	T1 Blue
Red harness wire to connection box wire	T3 Orange
White harness wire to connection box wire	T2 White

16. Insert the green with yellow stripe ground wire onto the ground screw and tighten using a #2 Phillips screwdriver.
17. Place the cover on the connection box making sure that the rubber gasket is properly aligned. Install four screws and secure with a #2 Phillips screwdriver.

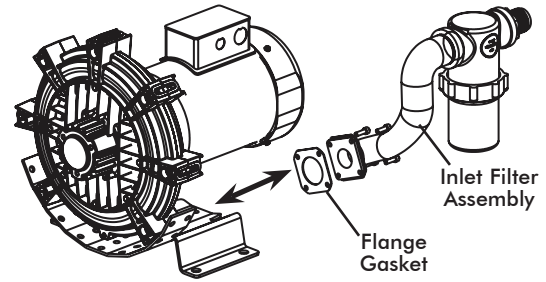

V3, V5 and V7 Vacuum Pump Inlet Filter Assembly

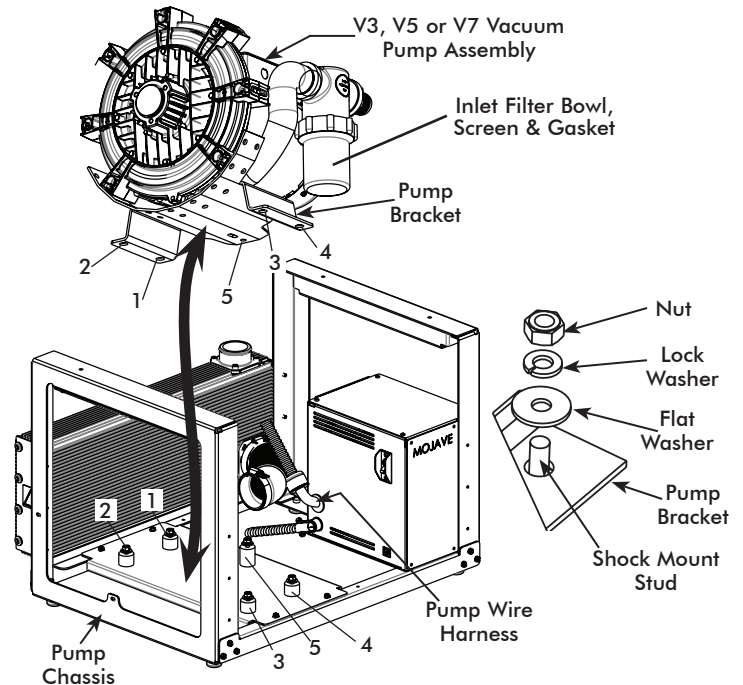

V3, V5 and V7 Vacuum Pump Replacement

Pump Reshipment Packaging

Refer to the Factory Reshipment Packing Instructions, P/N H5248, included in the kit and repackage the faulty vacuum pump to return it to the factory for evaluation. Use the original packing material that provides adequate coverage and protection of the pump during shipment.